

## COMM Download Option – Description for Start Stop Ultra Hands-Free Wireless Dictation Systems

- A download or dictate toggle switch box and powered USB Hub is located at each Dictation Station. This gives each user total individual control over whether they want to 1) dictate or 2) send the dictation on its way.

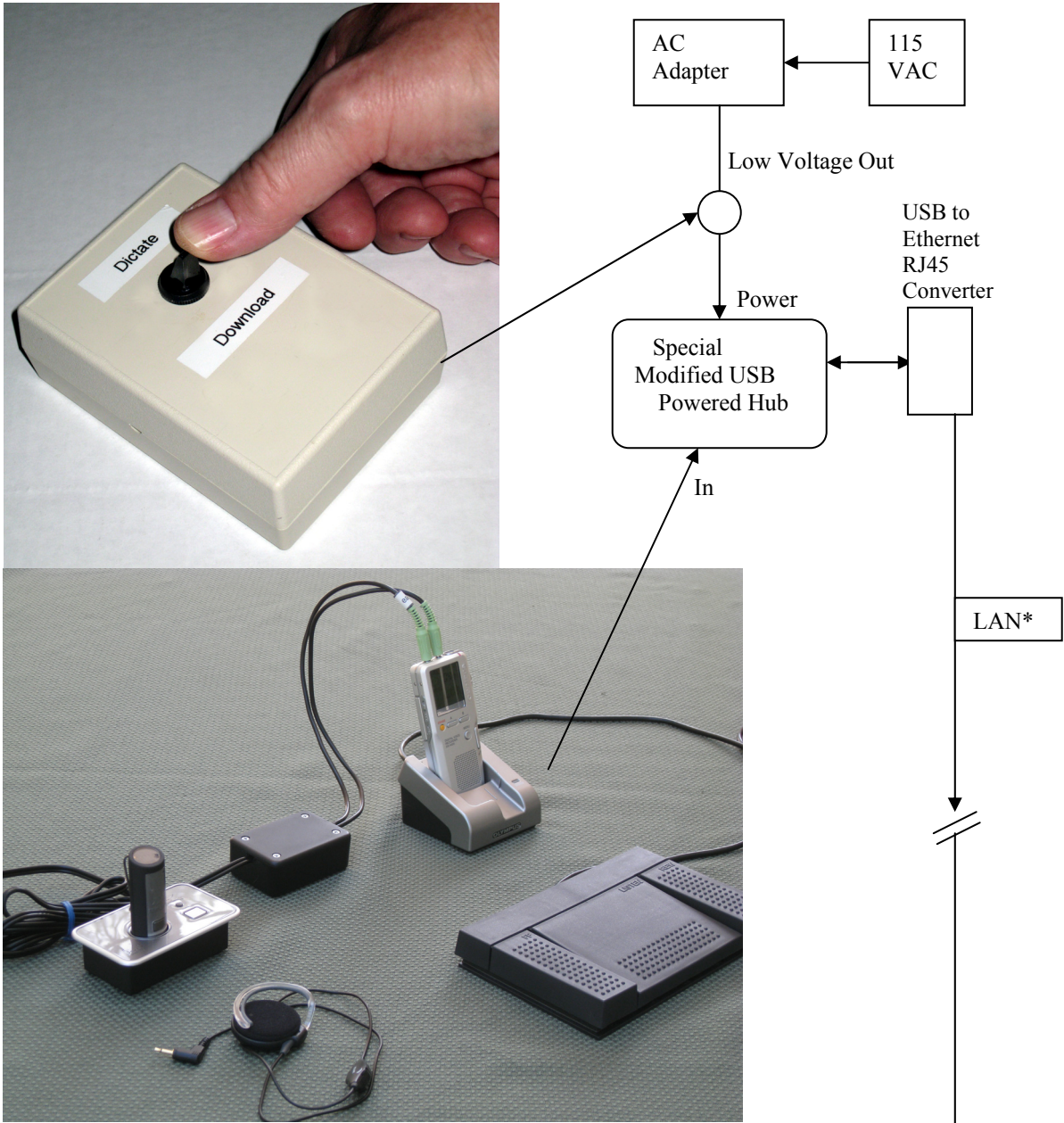

**Each Dictation Workstation consists of the items above the dotted line**

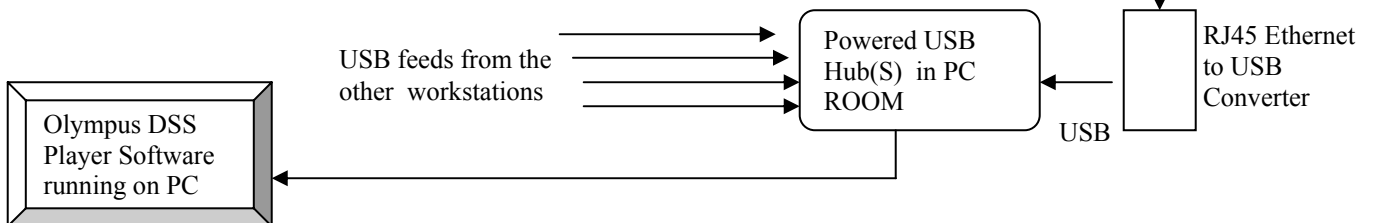

**Dictate/Download Switch Assembly Specifications:**

- Waterproof (Marine Grade) 2-position, flattened bat-toggle
- Switch Enclosure (Case): ABS GSM UL Rated 94 HB Plastic
- Switch is switching a low voltage (7.5 VDC) only; there is no shock hazard.
- Enclosure can be fastened to any flat surface using hi-temperature locking Velcro™, or lays flat enough on table to be operated with one hand.

Note: Customer supplies Cat 5 or Cat 6 cabling needed to go from Dictation area to PC room.

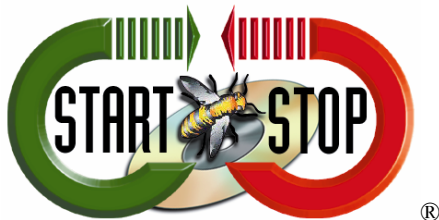

**Copyright 2008 All Rights Reserved**

**HTH Engineering, Inc.**

Tarpon Springs, FL 34688

Tel: (727) 493-4614 Toll-Free (866) 254-0714

FAX (810) 821-6940

Web: <http://www.startstop.com>